



San Diego Unified School District

PHYSICAL PLANT OPERATIONS CENTER ANNEX
4860 Ruffner Street, San Diego, CA 92111-1522

(858) 496-1902
Fax: (858) 496-1953

Graham Champion
Labor Compliance and
Construction Contracts Supervisor

August 17, 2018

Mr. Young Kang
Angeles Contractor, Inc.
783 Phillips Drive
City of Industry, CA 91748
ywkang@angelescontractor.com

Dear Mr. Kang:

Subject: CZ-17-0261-23 - Furnish and Install HVAC Systems and All Associated Work at District Sites – Region 4, Phase II (IDIQ) (SDUSD Project #92870071.1)

Notice to Proceed: No. 12R1 – Furnish & Install HVAC 2000 System at Washington Elementary School

This letter constitutes a revision to your notice to proceed with HVAC work at Washington ES per your proposal with the scope of work breakdown to Robert Daniels dated July 31, 2018, for a reduction of \$42,894.36, for the not-to-exceed amount of \$300,888.68.

Work began on January 15, 2018, and will be completed by September 6, 2018.

Please refer to this NTP number on all your correspondence and invoices.

Original invoice should be sent to:

San Diego Unified School District
PPO Center, Attn: Catherine Bendixen
4860 Ruffner Street
San Diego, CA 92111

Please call your construction manager if you have any questions regarding this NTP. Invoicing inquiries should be directed to Catherine Bendixen at (858) 637-6246.

Sincerely,

A handwritten signature in blue ink, appearing to read "G. Champion".

Graham Champion
Labor Compliance and Construction Contracts Supervisor

GC: mf

Attachment

C: D. Nestor, R. Daniels, M. Appanaitis, PSA



ANGELES CONTRACTOR, INC.
A general contractor

State Contr. Lic. 858483

TEL : (626) 923-3800

FAX : (626) 923-3801

783 Phillips Drive, City of Industry, CA 91748-1147

July 31, 2018

Robert Daniels

Construction Manager

SDUSD Facilities Construction

4860 Ruffner Street, San Diego, CA 92111

Cell: 619.748.8493

Email: rdaniels@sandi.net

Re: Washington ES NTP Pricing Decrease - Main Job
HVAC Phase 2/Region 4/Contract #CZ-17-0261-23

Mr. Daniels,

As required by CCD 06, 07 and RFI 11, Angeles Contractor agrees to the following Deductive Line Item costs:

Washington ES HVAC Phase 2/Region 4/Contract #CZ-17-0261-23
NTP #12 Main Project Value: \$343,783.04

Line item 562

Cost \$42.66

Quantity 900 Lineal Feet

Total (\$38,394.00)

Line Item 631

Cost \$41.67

Quantity 108 Lineal Feet

Total (\$4,500.36)

Total NTP Decrease Amount: (\$42,894.36)

Although Angeles Contractor has, to the best of our ability, tried to identify all line items and include them in the above listed cost, however, there may be potential situations where additional items may need to be added to the value in both the main project and the allowances. These added items may have been inadvertently overlooked during the bidding phase or purposely reduced by the District in the negotiation. Additional items may need to be added at the district's cost to complete the project as intended by the AE team. Angeles Contractor reserves the right to provide additional items as required to complete the project in both the main job and allowance values.

Regards,

A handwritten signature in black ink that reads "Adam Doty". The signature is written in a cursive style with a long horizontal stroke extending to the right.

Adam Doty
Project Manager
Angeles Contractor Inc.
858.322.1478 Cell

Washington ES 2228-D July 2018

Line Item	NTP Quantity	ACI QTY	AE QTY Bid	U.O.M	Item Description	Unit Price	Comments	Subcontractor	NTP Cost
0002	1	1	1	Each	Provide preconstruction photographic&DVD documentation for one school site.	\$ 1,250.00	ACI Added	ACI	\$ 1,250.00
0003	50	50	20	Each	Provide protection of Furnishings and Equipment in one room in accordance with Specification Section 01 50 00 3.4 FURNISHINGS AND EQUIPMENT PROTECTION.	\$ 90.40		HVAC Exchange	\$ 4,520.00
0004	120	120	257	Square Foot	Provide cutting, removal, and disposal of drywall surfaces as needed to facilitate the work. All materials removed shall become the property of the contractor or disposed of by the contractor according to Specification Sections 01 73 00 and 02 41 19 relating to the respective material removed and all applicable laws.	\$ 9.04		HVAC Exchange	\$ 1,084.80
0006	150	150	257	Square Foot	Provide patching using new materials and finishing of drywall surfaces as needed to facilitate the work in accordance with Specification Section 09 29 00. All work to match existing adjacent areas not removed,damaged or disturbed by the construction activities.	\$ 22.60		Pacific Systems	\$ 3,390.00
0007	700	250	700	Square Foot	Provide cutting, removal, and disposal of 12"x12" acoustical ceiling tiles and all substrates as needed to access the area of work and facilitate the work. Whether mechanically or adhesively applied all materials removed shall become the property of the contractor or disposed of by the contractor according to Specification Sections 01 73 00 and 02 41 19 relating to the respective material removed and all applicable laws.	\$ 7.34	Quantity increased per district	HVAC Exchange	\$ 5,138.00
0008	700	250	700	Square Foot	Provide 12"x12" acoustic ceiling panels tiles. Include substrate, furring, and/or shim strips as needed to match existing adjacent areas not removed, damaged or disturbed by the construction activities. Tiles to be either glued or mechanically fastened in accordance with Specification Section 09 51 13	\$ 28.28	Quantity increased per district	MT	\$ 19,796.00
0009	60	60	60	Square Foot	Provide cutting, removal, and disposal of plaster surfaces and substrate as needed to facilitate the work. All materials removed shall become the property of the contractor or disposed of by the contractor according to Specification Sections 01 73 00 and 02 41 19 relating to the respective material removed and all applicable laws.	\$ 10.17		HVAC Exchange	\$ 610.20

Line Item	NTP Quantity	ACI QTY	AE QTY Bid	U.O.M	Item Description	Unit Price	Comments	Subcontractor	NTP Cost
0010	60	60	60	Square Foot	Provide patching using new materials and finishing of plaster surfaces, including substrate, as needed to facilitate the work in accordance with Specification Section 09 24 00. All work to match existing adjacent areas not removed, damaged or disturbed by the cutting activities.	\$ 33.90		Pacific Systems	\$ 2,034.00
0013	900	900	935	Square Foot	Provide cutting, removal, and disposal of built-up roof surfaces as needed to facilitate the work. All materials removed shall become the property of the contractor or disposed of by the contractor according to Specification Sections 01 73 00, 04-74-49, and 02 41 19 relating to the respective material removed and all applicable laws.	\$ 1.97		Letner Roofing	\$ 1,773.00
0014	900	900	935	Square Foot	Provide patching using new materials and finishing of built-up roof surfaces as needed to facilitate the work in accordance with Specification Section 075113. All work to match existing adjacent areas not removed, damaged or disturbed by the cutting activities.	\$ 10.17		Letner Roofing	\$ 9,153.00
0020	0		1000	Square Foot	Provide landscaping where affected by the work. in accordance with Specification Section 32 84 00	\$ 5.65		MT	\$ -
0021	0		935	Square Foot	Removal and disposal of asbestos containing materials in accordance with Specification Section 02 82 33	\$ 22.60		Janus	\$ -
0025	110	110	72	Lineal Foot	Provide 8"x8" wood curb, cant strip and roof flashing for new AC unit platform See drawing on sheet_A502	\$ 52.83		MT	\$ 5,811.30
0032	300	660	317	Square Foot	Prepare, Caulk, Prime and Paint drywall or plaster surfaces.	\$ 3.39	Quantity decreased per district	RBE	\$ 1,017.00
0036	1200	1200		Square Foot	Prepare, Caulk, Prime and Paint galvanized steel ductwork in interior locations in accordance with Specification Section 09 91 23.	\$ 3.39		RBE	\$ 4,068.00
0040	240	240	500	Lineal Foot	Provide Temporary 6' Tall-Galvanized Chain Link Fence.	\$ 11.30		Rutt Fence	\$ 2,712.00

Line Item	NTP Quantity	ACI QTY	AE QTY Bid	U.O.M	Item Description	Unit Price	Comments	Subcontractor	NTP Cost
0046	6	6		Each	Provide 24"x24" walking pads on roof per A501.	\$ 45.20		Letner Roofing	\$ 271.20
0054	2	2		Each	Provide 6.0 Ton Packaged Rooftop Gas/Electric Unit, provide with hardwired thermostat and accessories (refer to MP-601). Include vibration isolation curb and power exhaust. Includes sensors and wiring as shown in sheets MP 702-705 as applicable.	\$ 13,220.77		Bay Air	\$ 26,441.54
0124	2	2		Each	Provide 3 Ton, 1200 CFM, Split System Furnace Forced Air Unit, DX Cooling Coil, and Outdoor Condensing Unit, provide with hardwired thermostat and accessories (refer to MP-605). Includes sensors and wiring as shown in sheets MP 702-705 as applicable.	\$ 5,816.72		Bay Air	\$ 11,633.44
0137	205	205		Lineal Foot	Provide Type ACR, Hard Drawn, 3/8" Refrigerant Piping, fittings, hangers and supports	\$ 28.25		JDS	\$ 5,791.25
0138	205	205	125	Lineal Foot	Provide Type ACR, Hard Drawn, 3/4" Refrigerant Piping, fittings, hangers and supports	\$ 31.07		JDS	\$ 6,369.35
0145	205	205	125	Lineal Foot	Provide flexible, closed cell elastomeric pipe insulation.	\$ 10.17		JDS	\$ 2,084.85
0149	66	66	24	Lineal Foot	Provide Flexible Connection with metal ledge	\$ 2.82		Bay Air	\$ 186.12
0150	24	24	8	Each	Provide Manual volume damper up to 18" x 18"	\$ 74.71		Bay Air	\$ 1,793.04
0151	2	2		Each	Provide Intake Louver - 36"x18"	\$ 334.25		Bay Air	\$ 668.50
0155	4	4	4	Each	Provide 4-way square neck supply diffuser with opposed blade damper	\$ 126.28		Bay Air	\$ 505.12
0157	4	4	4	Each	Provide Fixed grille with opposed blade damper	\$ 105.81		Bay Air	\$ 423.24
0159	1	1	1	Each	Provide Wireless coordinator with patch cord (Viconics or equal)	\$ 664.71		Bay Air	\$ 664.71

Line Item	NTP Quantity	ACI QTY	AE QTY Bid	U.O.M	Item Description	Unit Price	Comments	Subcontractor	NTP Cost
0162	88	88		Square Foot	Provide Mineral Fiber Glass Duct Wrap Insulation - 1-1/2in thick, 1.50lb/cu. Ft., FSK Vapor Barrier	\$ 2.72		Bay Air	\$ 239.36
0164	0	88		Square Foot	Provide Mineral Fiber Glass Interior Duct Liner - 1-1/2in thick, 1.50lb/cu. Ft.	\$ 3.25	Quantity reduced per district	Bay Air	\$ -
0165	0	574	250	Square Foot	Provide Mineral Fiber Glass Interior Duct Liner - 2in thick, 1.50lb/cu. Ft.	\$ 3.90	Quantity reduced per district	Bay Air	\$ -
0169	87	87		Pound	Provide Interior Exposed - Rectangular galvanized steel ductwork and fittings.	\$ 22.41		Bay Air	\$ 1,949.67
0170	212	212		Pound	Provide Interior Concealed - Rectangular galvanized steel ductwork and fittings.	\$ 14.00		Bay Air	\$ 2,968.00
0175	23	23	24	Lineal Foot	Provide Interior Exposed - 16" Diameter 24 ga., Spiral preformed, galvanized steel round ductwork, fittings, hangers and supports.	\$ 52.22		Bay Air	\$ 1,201.06
0177	23	23	44	Lineal Foot	Provide Interior Exposed - 20" Diameter 24 ga., Spiral preformed, galvanized steel round ductwork, fittings, hangers and supports.	\$ 63.59		Bay Air	\$ 1,462.57
0178	22	22		Lineal Foot	Provide Interior Exposed - 22" Diameter 24 ga., Spiral preformed, galvanized steel round ductwork, fittings, hangers and supports.	\$ 71.03		Bay Air	\$ 1,562.66
0179	32	32		Lineal Foot	Provide Interior Exposed - 24" Diameter 24 ga., Spiral preformed, galvanized steel round ductwork, fittings, hangers and supports.	\$ 76.41		Bay Air	\$ 2,445.12
0181	8	8		Lineal Foot	Provide Interior Concealed - 8" Diameter 26 ga., Spiral preformed, galvanized steel round ductwork, fittings, hangers and supports.	\$ 25.89		Bay Air	\$ 207.12
0182	12	12	20	Lineal Foot	Provide Interior Concealed - 10" Diameter 26 ga., Spiral preformed, galvanized steel round ductwork, fittings, hangers and supports.	\$ 32.97		Bay Air	\$ 395.64
0184	12	12	14	Lineal Foot	Provide Interior Concealed - 14" Diameter 26 ga., Spiral preformed, galvanized steel round ductwork, fittings, hangers and supports.	\$ 40.39		Bay Air	\$ 484.68
0196	0	32		Each	Provide Duct Supports - Rectangular trapeze bar hangers with all thread rod interior (refer to details 1 & 3/MS-1)	\$ 99.18	Quantity reduced per district	Bay Air	\$ -

Line Item	NTP Quantity	ACI QTY	AE QTY Bid	U.O.M	Item Description	Unit Price	Comments	Subcontractor	NTP Cost
0200	0	16		Each	Provide additional Duct Supports not already included in duct installation line item (as requested by the District) - Round duct strap hangers (refer to details 2-5/(MS-2)	\$ 17.56	"Straps for Rec included in specs" Quantity reduced per district	Bay Air	\$ -
0212	2		2	Each	Provide capping of heating hot water piping.	\$ 226.00	Quantity increased per district	JDS	\$ 452.00
0232	1000	2130	570	Pound	Provide Outdoor Roof-Mounted - Rectangular galvanized steel ductwork, fittings, hangers and supports. Unit of measure for pricing is to be based on the net weight of ducts only and does not include fittings, hangers, supports, or other appurtenances.	\$ 39.73	Net Cost of duct work. All vains bolts etc included in line item Quantities decreased per district	Bay Air	\$ 39,730.00
0233	26	26	24	Each	For each supply register, return register, exhaust register, and diffuser: Provide Test and Balance of their respective HVAC System in accordance to project specifications.	\$ 198.25		Bay Air	\$ 5,154.50
0235	2	2	2	Each	Provide one 250 volt, 30 amp, 3 pole fused disconnect switch complete with appropriate sized fuse(s) including mounting and connection to mechanical equipment. Nema 3R	\$ 536.75		Southland	\$ 1,073.50
0239	2	2	2	Each	Provide one 250 volt, 60 amp, 3 pole fused disconnect switch complete with appropriate sized fuse(s) including mounting and connection to mechanical equipment. Nema 3R	\$ 610.20		Southland	\$ 1,220.40
0251	7	7	6	Each	Provide one 2 pole thermal switch including mounting connection to mechanical equipment.	\$ 372.90		Southland	\$ 2,610.30
0252	4	4	2	Each	Provide outdoor, weatherproof GFI duplex receptacle mounted to the side of mechanical equipment.	\$ 124.30		Southland	\$ 497.20
0262	2	4		Each	Provide code sized, weatherproof junction box, maximum 4"x4"x4", including mounting	\$ 152.55	Added. Waterproof j box included in	Southland	\$ 305.10
0263	2	2		Each	Provide indoor duplex receptacle including mounting and connection to the pump.	\$ 211.31	ACI Added	Southland	\$ 422.62
0264	490	490		Lineal Foot	Provide 3/4" EMT conduit including couplings, bends and required supports	\$ 9.04		Southland	\$ 4,429.60
0265	500	500	700	Lineal Foot	Provide 3/4" rigid galvanized conduit including couplings all fittings-bene-and required supports. Reef-mounted-on-Durablcks	\$ 12.99		Southland	\$ 6,495.00
0269	175	175	450	Lineal Foot	Provide 1 1/4" rigid galvanized conduit including couplings all fittings-bene-and required supports. Reef-mounted-on-Durablcks	\$ 20.34		Southland	\$ 3,559.50

Line Item	NTP Quantity	ACI QTY	AE QTY Bid	U.O.M	Item Description	Unit Price	Comments	Subcontractor	NTP Cost
0279	240	240	200	Lineal Foot	Provide 3" rigid galvanized conduit including couplings all fittings-bend-and required supports. Roof-mounted-on Durablocks	\$ 55.37		Southland	\$ 13,288.80
0280	40	40	50	Lineal Foot	Provide 3" PVC conduit including couplings, bends and required supports.	\$ 39.55		Southland	\$ 1,582.00
0284	284	2070	1000	Lineal Foot	Provide #12 THWN wire installed in new or existing conduit or raceway	\$ 0.73	NEED MORE!! TYPO???	Southland	\$ 207.32
0285	1640	1640		Lineal Foot	Provide #12 XHHW wire installed in new or existing conduit or raceway	\$ 1.86		Southland	\$ 3,050.40
0287	210	210		Lineal Foot	Provide #10 XHHW wire installed in new or existing conduit or raceway	\$ 1.97		Southland	\$ 413.70
0293	956	956		Lineal Foot	Provide #4 XHHW wire installed in new or existing conduit or raceway	\$ 2.26		Southland	\$ 2,160.56
0309	1304	1304		Lineal Foot	Provide 250kCM XHHW wire installed in new or existing conduit or raceway	\$ 8.47		Southland	\$ 11,044.88
0321	0	100	20	Lineal Foot	Provide surface preparation and paint EMT or Rigid conduit to match adjacent surface.	\$ 3.39	ACI Added	RBE	\$ -
0326	1	1	1	Each	Provide 400 amp, 208Y/120 volt panelboard with 400 amp main breaker complete with copper bussing and provisions for bolt-on breakers. Nema 1 enclosure. Provide feeder breaker at source to match main breaker rating. Provide grounding to new ground rod and/or cold water piping as required. 42kAIC, 42 circuit minim. Include landing of all wiring on breakers and testing of all breakers as required by the specification section 26 01 20.	\$ 3,248.75		Southland	\$ 3,248.75
0352	3	3		Each	Provide 15-30 amp, 1 pole bolt-on circuit breaker, 250 volt class, 10KAIC	\$ 22.60		Southland	\$ 67.80
0355	2	2		Each	Provide 15-100 amp, 2 pole bolt-on circuit breaker 250 volt class, 10KAIC. Provide testing as required by specification section 26 01 20.	\$ 158.20		Southland	\$ 316.40
0356	4	4		Each	Provide 15-100 amp, 3 pole bolt-on circuit breaker 250 volt class, 10KAIC. Provide testing as required by specification section 26 01 20.	\$ 113.00		Southland	\$ 452.00
0368	1			Each	Provide 225-400 amp, 3 pole bolt-on circuit breaker 250 volt class, 42kAIC. Provide testing as required by specification section 26 01 20.	\$ 1,073.50	Quantity increased per district	Southland	\$ 1,073.50

Line Item	NTP Quantity	ACI QTY	AE QTY Bid	U.O.M	Item Description	Unit Price	Comments	Subcontractor	NTP Cost
0386	40	40		Lineal Foot	Provide trench, removal of spoils, compacted backfill with slurry encasement for a 12" wide by 36" deep ductbank. Include clearing as required per spec section 311000	\$ 51.98		Southland	\$ 2,079.20
0397	4	4	4	Each	Provide connection to a fire/smoke damper and module including junction box, switch and flex connection. Include all required testing.	\$ 1,209.10	ACI Added	MT	\$ 4,836.40
0455	1	2		Each	Provide 18" square by 6" deep pullbox, Nema 3R	\$ 452.00	Quantity reduced per district	Southland	\$ 452.00
0472	30	30		Lineal Foot	Provide 3/4" liquid tight flexible conduit including all fittings and supports	\$ 16.95		Southland	\$ 508.50
0474	10	10		Lineal Foot	Provide 1 1/2" liquid tight flexible conduit including all fittings and supports	\$ 45.20		Southland	\$ 452.00
0478	120	120	170	Lineal Foot	Provide painted 3/4" Type M copper condensate drain pipe including all couplings, unions, bends, tees and roof supports. Clean and paint piping and supports with one coat exterior latex.	\$ 32.96		MT	\$ 3,955.20
0480	60	60	80	Lineal Foot	Provide painted 1-1/4" to 1-1/2" Type M copper condensate drain pipe including all couplings, unions, bends, tees and roof supports. Clean and paint piping and supports with one coat exterior latex.	\$ 46.16		MT	\$ 2,769.60
0483	90	90		Lineal Foot	Provide 3/4" to 1" Type M copper condensate drain pipe with 1" polyolefin insulation and aluminum jacket painted to match wall and including all couplings, unions, bends, tees and hangers/supports.	\$ 56.50		MT	\$ 5,085.00
0484	4	4		Each	Provide 3/4" to 1" Type M copper condensate drain trap with vent, cleanout and (2) unions.	\$ 220.35		JDS	\$ 881.40
0486	92	92	100	Lineal Foot	Provide 3/4" to 1" ASTM A53 Sch. 40 black steel pipe including all couplings, unions, bends, tees and supports/hangers. Interior only.	\$ 47.46		JDS	\$ 4,366.32
0488	120	120		Lineal Foot	Provide 3/4" to 1" ASTM A53 Sch. 40 black steel pipe including all couplings, unions, bends, tees and roof supports. Clean, prime and paint pipe.	\$ 37.29		MT	\$ 4,474.80
0489	70	70		Lineal Foot	Provide 1-1/4" to 1-1/2" ASTM A53 Sch. 40 black steel pipe including all couplings, unions, bends, tees and roof supports. Clean, prime and paint pipe.	\$ 45.20		MT	\$ 3,164.00
0496	2	3	2	Each	Provide 3/4" to 1" condensate drain connection to sink trap.	\$ 163.85	Quantity reduced per district	JDS	\$ 327.70

Line Item	NTP Quantity	ACI QTY	AE QTY Bid	U.O.M	Item Description	Unit Price	Comments	Subcontractor	NTP Cost
0501	2	2		Each	Provide 1-1/4" to 1-1/2" gas pipe connection to existing gas piping with gas cock and union.	\$ 276.85		JDS	\$ 553.70
0502	1	1		Each	Provide 2" to 2-1/2" gas pipe connection to existing gas piping with gas cock and union.	\$ 678.00		JDS	\$ 678.00
0503	4	4		Each	Provide connection to furnace/gas fired package unit with pipe size reducing fitting, 3/4" to 1" stainless steel flexible hose, 3/4" to 1" gas cock, union and drip leg.	\$ 315.27		JDS	\$ 1,261.08
0504	66	66		Each	Provide prefabricated adjustable height galvanized steel roof supports with polyethylene base. (refer to detail 7/MS2)	\$ 113.00		JDS	\$ 7,458.00
0505	6	33		Each	Provide roof penetration for 3/4" to 1" pipe with galvanized steel flashing and sealant.	\$ 73.45	Quantity reduced per district	Letner Roofing	\$ 440.70
0511	2	2	2	Each	Provide condensate pump with 1/2 gallon reservoir, 1/30 hp at 120 volt 1 ph and supports to structure.	\$ 282.50		JDS	\$ 565.00
0512	0	1	1	Each	Provide 3/4" to 1" gas valve with union.	\$ 113.00	1. In line item 500.Quantity reduced per district	JDS	\$ -
0513	0	3	3	Each	Provide 1-1/4" to 1-1/2" gas valve with union.	\$ 158.20	CI Added.Quantity reduced per district	JDS	\$ -
0519	1	1		Each	Provide 1-1/2" double diaphragm 5 psi to 7 inch water column gas pressure regulator with overpressure regulating device	\$ 389.85		JDS	\$ 389.85
0541	900			Square Foot	Demo existing 2" roof planks	\$ 3.95	Quantity increased per district	MT	\$ 3,555.00
0562	0			Lineal Foot	Sister & Provide New 3 1/2x16 LVL (16 foot minimum) per 3A/TS250	\$ 42.66	Not Required per CCD 07 Quantity increased per district	Rocky Coast	\$ -
0580	8	8		Each	Provide Spring Hanger per 10/TS253, or 10/TS352	\$ 447.15		MT	\$ 3,577.20
0595	4	4	4	Each	Provide Mechanical unit roof framing per 1/S310 or 1/S210	\$ 1,588.62		Rocky Coast	\$ 6,354.48
0598	4	4		Each	Provide Jacking up of existing framing per 5/S210 or 5/S310	\$ 135.22		Rocky Coast	\$ 540.88
0608	2	4	2	Each	Provide Suspended platform for up to 10 ton unit per 1/S211, or 1/S311	\$ 2,448.05	Quantity decreased per district	MT	\$ 4,896.10

Line Item	NTP Quantity	ACI QTY	AE QTY Bid	U.O.M	Item Description	Unit Price	Comments	Subcontractor	NTP Cost
0631	0	108		Lineal Foot	Provide 1 3/4 x 11 7/8 each side Girder reinforcement (12 feet min.) per 1C of table C/5220	\$ 41.67	Not Required per CCD 07	Rocky Coast	\$
0681	4	4		Each	Provide tapered rigid insulation board type roof cricket and associated flashings per detail 01B, spec section 07 51 13, and approved construction documents. Max. 4"W x 4"L.	\$ 169.50		Letner Roofing	\$ 678.00
0684	40	40	83	Each	Remove, protect, and reinstall existing 2' x 4' T-bar ceiling panels as needed to facilitate the installation of the work.	\$ 27.12	41 ea. Removed April. Billing for half. Complete remainder at reinstall.	Pacific Systems	\$ 1,084.80
0685	60	60	140	Each	Remove, protect, and reinstall existing T-Bar ceiling supports as needed to facilitate the installation of the work.	\$ 9.04	12 ea. Removed April. Billing for half. Complete remainder at reinstall.	Pacific Systems	\$ 542.40
Totals									\$ 300,888.68
Totals									NTP Cost

\$	300,888.68	NTP Amount
\$	11,756.44	Main plus approved Overages
\$	11,756.44	Main, Approved overages and Pending overages
\$	289,132.24	Under Main plus Overage
\$	(289,132.24)	Under plus Approved Overages and

Original NTP12

Line Item	NTP Quantity	U.O.M	Item Description	Unit Price	Comments	Subcontractor	NTP Cost
0513	0	Each	Provide 1-1/4" to 1-1/2" gas valve with union.	\$ 158.20	ACI Added Quantity reduced per district	JDS	\$
0519	1	Each	Provide 1-1/2" double diaphragm 5 psi to 7 inch water column gas pressure regulator with overpressure regulating device	\$ 389.85		JDS	\$ 389.85
0541	900	Square Foot	Demo existing 2" roof planks	\$ 3.95	Quantity increased per district	MT	\$ 3,555.00
0562	900	Lineal Foot	Sister & Provide New 3 1/2x16 Ilt. (16 foot minimum) per 3A/TS250	\$ 47.66	Quantity increased per district	Rocky Coast	\$ 38,394.00
0580	8	Each	Provide Spring Hanger per 10/TS253, or 10/TS332	\$ 407.15		MT	\$ 3,257.20
0595	4	Each	Provide Mechanical unit roof framing per 1/5310 or 1/5210	\$ 1,588.62		Rocky Coast	\$ 6,354.48
0598	4	Each	Provide Jacking up of existing framing per 5/5210 or 5/5310	\$ 135.22		Rocky Coast	\$ 540.88
0608	2	Each	Provide Suspended platform for up to 10 ton unit per 1/5211, or 1/5311	\$ 2,448.05	Quantity decreased per district	MT	\$ 4,896.10

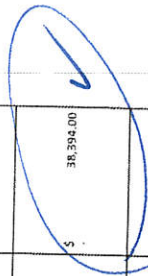

Original NTP12

Main Item	NTP Quantity	U.O.M	Item Description	Unit Price	Comments	Subcontractor	NTP Cost
0631	108	Linear Foot	Provide 1 3/4 x 11 7/8 each side girder reinforcement (12 feet min.) per 1 C of table C/S220	\$ 41.67		Rocky Coast	\$ 4,500.36
0681	4	Each	Provide tapered rigid insulation board type roof cricket and associated flashings per detail 015, spec section 07 51 13, and approved construction documents. Max. 4'W x 4'L	\$ 159.50		Letner Roofing	\$ 638.00
0684	40	Each	Remove, protect, and reinstall existing 2'x4' T-bar ceiling panels as needed to facilitate the installation of the work.	\$ 27.12		Pacific Systems	\$ 1,084.80
0685	60	Each	Remove, protect, and reinstall existing T-Bar ceiling supports as needed to facilitate the installation of the work.	\$ 9.04		Pacific Systems	\$ 542.40
Totals							\$ 343,783.04 ✓
							NTP Cost

Constructed NTP
12-29-17
343,783.04

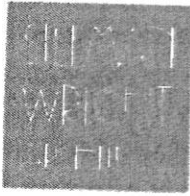

Owner
Architect
Consultant
Contractor
Field
Other

ARCHITECT'S SUPPLEMENTAL INSTRUCTIONS

PROJECT: Washington Elementary School
(Name) 1789 State Street
(Address) San Diego, CA 92101

ARCHITECT'S SUPPLEMENTAL
INSTRUCTION # 007

OWNER: San Diego Unified School District
4860 Ruffner Street
San Diego, CA 92111

DATE OF ISSUANCE: April 24, 2018

TO: Angeles Contractor, Inc.
(Contractor) 783 Phillips Drive
City of Industry, CA 91748-1147

ARCHITECT: Silliman Wright Architects
7515 Metropolitan Dr., Suite 400
San Diego, CA 92108

ARCHITECT'S PROJECT NO. 16048

The Work shall be carried out in accordance with the following supplemental instructions issued in accordance with the Contract Documents without change in Contract Sum or Contract Time. Proceeding with the Work in accordance with these instructions indicates your acknowledgement that there will be no change in the Contract Sum or Contract Time.

Description: ASI #007 - LVL Installation (RFI's 5 & 7)

A. INSTRUCTIONS:

1. Sheet S-001 and S-101

- i. Due to (E) 4x8 cross beams, we were unable to reinforce the (E) 6x18 with 14" deep LVLs. For constructability, a 3 1/2" x 5 1/2" LVL will be placed on the bottom of the (E) 6x18 instead of sistering on to the sides of the beam. In addition, if the mechanical equipment lands on an (E) 4x8 cross beam, then that cross beam will be reinforced with LVLs sistered on both sides. See added detail 2/S-001 and revised sheet S-101 for changes.

ISSUED BY _____

Jeff Ramirez
Silliman Wright Architects

BWE

STRUCTURAL ENGINEERING • CIVIL ENGINEERING • SURVEYING • LAND PLANNING

A # 04 - 116274
File # 37-58
CCD A 07
ASI # 07
Date: April 24, 2018
Engineer: Dave Adams
Project: Washington Elementary School
Job Number: 12598A.1.00

CCD #07 Memo/Narrative

Due to (E) 4x8 cross beams, we were unable to reinforce the (E) 6x18 with 14" deep LVLs. For constructability, a 3 1/2" x 5 1/2" LVL will be placed on the bottom of the (E) 6x18 instead of sistering on to the sides of the beam. In addition, if the mechanical equipment lands on an (E) 4x8 cross beam, then that cross beam will be reinforced with LVLs sistered on both sides. See added detail 2/S-001 and revised sheet S-101 for changes.



APPROVED
DAVE K. ADAMS
116274 DATE: 04.30.18